

**PLANNING COMMISSION
CHARTER TOWNSHIP OF CANTON
NOTICE OF PUBLIC HEARING**

PROPOSED AMENDMENT TO THE ZONING ORDINANCE OF THE CHARTER TOWNSHIP OF CANTON, WAYNE COUNTY, MICHIGAN.

NOTICE IS HEREBY GIVEN pursuant to Michigan Public Act 110 of 2006, of the State of Michigan, as amended, and pursuant to the Zoning Ordinance of the Charter Township of Canton that the Planning Commission of the Charter Township of Canton will hold a Public Hearing on Monday October 7, 2013 in the *First Floor Meeting Room of the Canton Township Administration Building, 1150 S. Canton Center Road at 7:00 p.m.* on the following proposed amendment to the Zoning Ordinance:

AN ORDINANCE AMENDING APPENDIX A - ZONING, OF THE CODE OF ORDINANCES OF THE CHARTER TOWNSHIP OF CANTON, MICHIGAN, BY AMENDING ARTICLE 8.00 - AMENDING THE DISTRICT BOUNDARIES ON THE ZONING MAP AS FOLLOWS;

TDM HOLDINGS EAST REZONING - CONSIDER REQUEST TO REZONE PARCEL NO. 076 99 0002 000 (50224 PROCTOR) AND 076 99 0004 000 (49940 PROCTOR) FROM RA, RURAL AGRICULTURAL TO R-3, SINGLE-FAMILY RESIDENTIAL. Property is located north of Proctor between Denton and Ridge Roads.

Written comments addressed to the Planning Commission should be received at the Canton Township Administration Building, 1150 Canton Center S. prior to Thursday, October 3, 2013 in order to be included in the materials submitted for review.

SEE ATTACHED MAP

EC091913-0815 2.5 x 10.076

Greg Greene, Chairman

Publish: Newspaper -- September 19, 2013

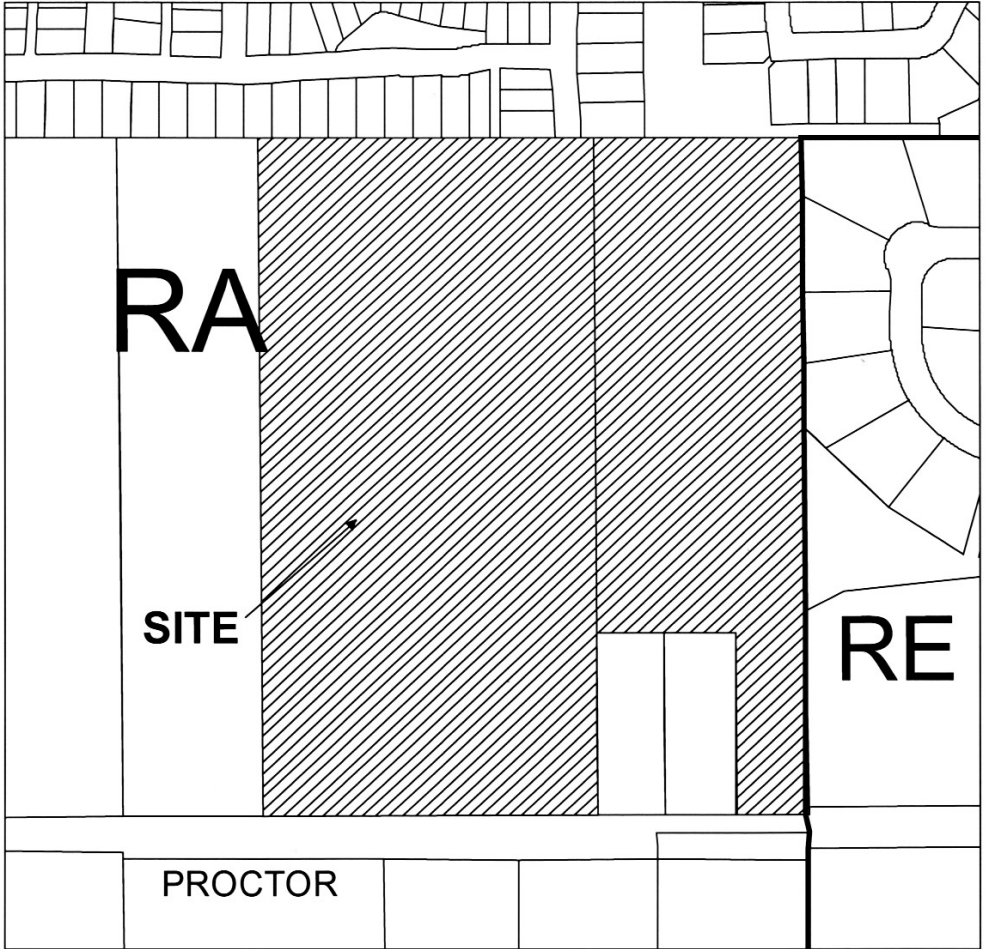

TDM Holdings, LLC - EAST 076-RZ-1698

Zoning			
WC WETLANDS CONSERVATION	R-3 SINGLE FAMILY RESIDENTIAL	C-1 VILLAGE SHOPPING	OSP OFF STREET PARKING
RA RURAL AGRICULTURAL	R-4 SINGLE FAMILY RESIDENTIAL	C-2 COMMUNITY COMMERCIAL	LI-1 LIGHT INDUSTRIAL
RR RURAL RESIDENTIAL	R-5 SINGLE FAMILY RESIDENTIAL	C-3 REGIONAL COMMERCIAL	LI-2 LIGHT INDUSTRIAL
RE RURAL ESTATE	R-6 SINGLE FAMILY ATTACHED RESIDENTIAL	C-4 INTERCHANGE SERVICE	LJR RESEARCH PARK
R-1 SINGLE FAMILY RESIDENTIAL	MR MULTIPLE FAMILY RESIDENTIAL	O-1 OFFICE	GI GENERAL INDUSTRIAL
R-2 SINGLE FAMILY RESIDENTIAL	RMH MOBILE HOME PARK	MRD MID-RISE DEVELOPMENT	

