

PLANNING COMMISSION
CHARTER TOWNSHIP OF CANTON
NOTICE OF PUBLIC HEARING

PROPOSED AMENDMENT TO THE ZONING ORDINANCE OF THE CHARTER TOWNSHIP OF CANTON, WAYNE COUNTY, MICHIGAN.

NOTICE IS HEREBY GIVEN pursuant to Michigan Public Act 110 of 2006, of the State of Michigan, as amended, and pursuant to the Zoning Ordinance of the Charter Township of Canton that the Planning Commission of the Charter Township of Canton will hold a Public Hearing on Wednesday, January 11, 2023 at 7:00 p.m. in the **First Floor Meeting Room of the Canton Township Administration Building, 1150 S. Canton Center Road, Canton, MI 48188** on the following proposed amendment to the Canton Township Zoning Ordinance:

TREMONT PLACE (FORMERLY NAMED WELLINGTON ON THE WILLOW AND TREMONT PLACE) PLANNED DEVELOPMENT DISTRICT (PDD) AMENDMENT - Consider request to amend the Planned Development District as permitted in Section 27.04 of the Zoning Ordinance for the purpose of making development changes on parcel nos.: 049-99-0001-712, 049-99-0001-713, 049-99-0001-714 (1632 Lotz N.), and 049-99-0001-716. Properties are located on the east side of N. Lotz Rd. and south of Ford Road.

Public comments may be made during the meeting. Written comments addressed to the Planning Commission must be received by 4:30 p.m. on Wednesday, January 11, 2023. Written comments may be emailed to patrick.sloan@cantonmi.gov or delivered to the Township Administration Building at 1150 S Canton Center Rd., Canton, MI 48188.

SEE ATTACHED MAP

Greg Greene, Chairman

Publish: Newspaper - December 22, 2022

CN2466 - 122222 2.5 x 9.646

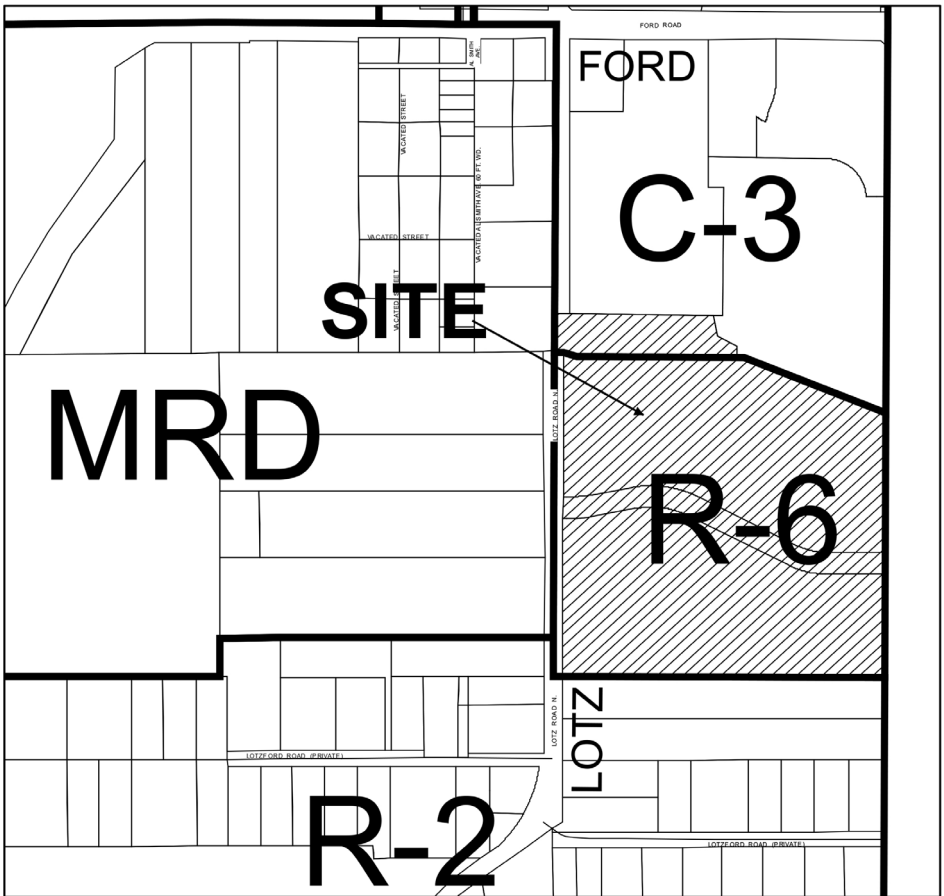

Tremonte Place PDD Amend. 049-PDDA-7585

Zoning			
WC WETLANDS CONSERVATION	R-3 SINGLE FAMILY RESIDENTIAL	C-1 VILLAGE SHOPPING	OSP OFF STREET PARKING
RA RURAL AGRICULTURAL	R-4 SINGLE FAMILY RESIDENTIAL	C-2 COMMUNITY COMMERCIAL	LI LIGHT INDUSTRIAL
RR RURAL RESIDENTIAL	R-5 SINGLE FAMILY RESIDENTIAL	C-3 REGIONAL COMMERCIAL	LI-R RESEARCH PARK
RE RURAL ESTATE	R-6 SINGLE FAMILY ATTACHED RESIDENTIAL	C-4 INTERCHANGE SERVICE	GI GENERAL INDUSTRIAL
R-1 SINGLE FAMILY RESIDENTIAL	MR MULTIPLE FAMILY RESIDENTIAL	O-1 OFFICE	
R-2 SINGLE FAMILY RESIDENTIAL	RMH MOBILE HOME PARK	MRD MID-RISE DEVELOPEMENT	

