

**PLANNING COMMISSION
CHARTER TOWNSHIP OF CANTON
NOTICE OF PUBLIC HEARING**

PROPOSED AMENDMENT TO THE ZONING ORDINANCE OF THE CHARTER TOWNSHIP OF CANTON, WAYNE COUNTY, MICHIGAN.

NOTICE IS HEREBY GIVEN pursuant to Michigan Public Act 110 of 2006, of the State of Michigan, as amended, and pursuant to the Zoning Ordinance of the Charter Township of Canton that the Planning Commission of the Charter Township of Canton will hold a Public Hearing on **Monday, September 12, 2022 at 7:00 p.m. in the First Floor Meeting Room of the Canton Township Administration Building, 1150 S. Canton Center Road, Canton, MI 48188** on the following proposed amendment to the Canton Township Zoning Ordinance:

CREEKVIEW LANDINGS PLANNED DEVELOPMENT DISTRICT (PRELIMINARY PDD) - Consider request to establish a Planned Development District as permitted in Section 27.04 of the Zoning Ordinance on part of parcel nos.: 118-99-0005-000; 119-99-0001-702; 119-99-0002-001; 119-99-0003-001; 119-99-0007-000 (50400 Geddes Rd.); 120-99-0002-000; 120-99-0003-000 (50356 Geddes Rd.); 120-99-0004-701 (50300 Geddes Rd.); 120-99-0006-000 (50200 Geddes Rd.); 120-99-0009-001 (50760 Geddes Rd.); 120-99-0015-000 (49952 Geddes Rd.); 120-99-0016-000 (49940 Geddes Rd.); 120-99-0017-001 (49828 Geddes Rd.); 120-99-0017-002 (49828 Geddes Rd.); and 120-99-0018-702 (3506 Denton Rd.). Property is located north of Geddes Road and west of Denton Road. Proposed use is a residential development of 449 dwelling units on 224.6 acres.

Public comments may be made during the meeting. Written comments addressed to the Planning Commission should be received by 4:30 p.m. on Monday, September 12, 2022. Written comments may be emailed to patrick.sloan@cantonmi.gov or delivered to the Township Administration Building at 1150 S Canton Center Rd., Canton, MI 48188.

SEE ATTACHED MAP

Greg Greene, Chairman
Publish: Newspaper - August 25, 2022

CN2423 - 082522 2.5 x 9.901

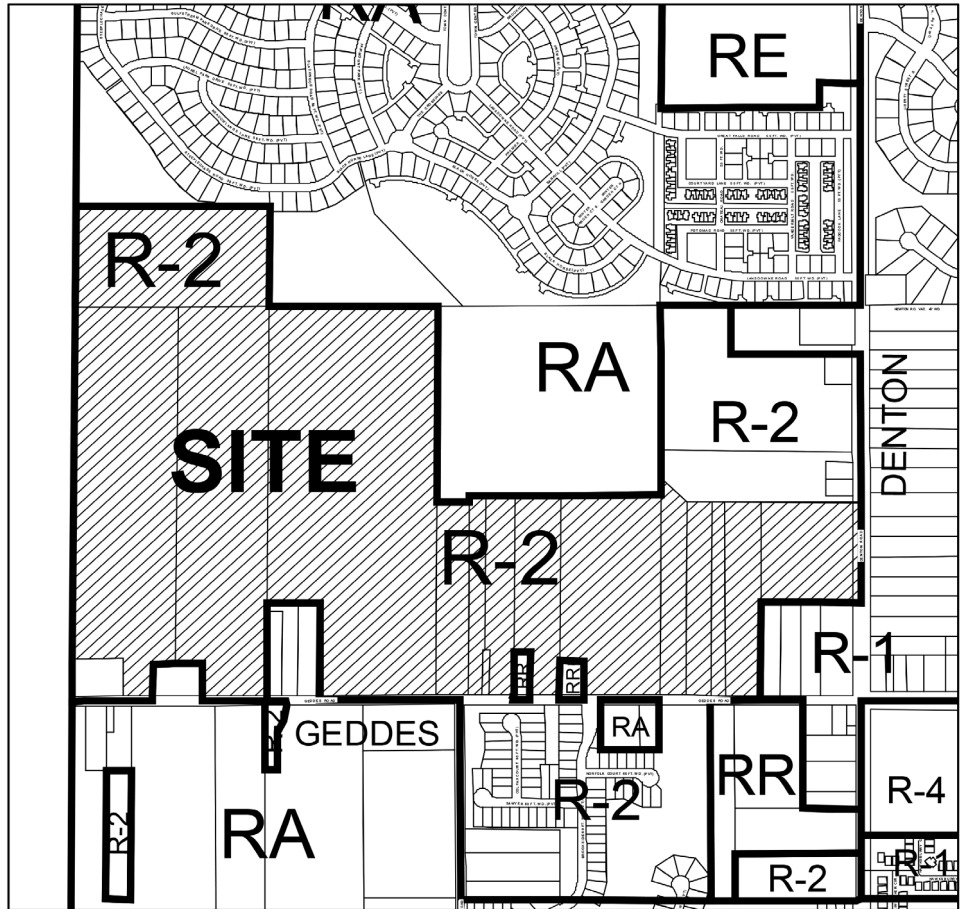

Creekview Landings 120-PDP-6C 11

Zoning			
WC WETLANDS CONSERVATION	R-3 SINGLE FAMILY RESIDENTIAL	C-1 VILLAGE SHOPPING	OSP OFF STREET PARKING
RA RURAL AGRICULTURAL	R-4 SINGLE FAMILY RESIDENTIAL	C-2 COMMUNITY COMMERCIAL	LI LIGHT INDUSTRIAL
RR RURAL RESIDENTIAL	R-5 SINGLE FAMILY RESIDENTIAL	C-3 REGIONAL COMMERCIAL	LIR RESEARCH PARK
RE RURAL ESTATE	R-6 SINGLE FAMILY ATTACHED RESIDENTIAL	C-4 INTERCHANGE SERVICE	GI GENERAL INDUSTRIAL
R-1 SINGLE FAMILY RESIDENTIAL	MR MULTIPLE FAMILY RESIDENTIAL	O-1 OFFICE	
R-2 SINGLE FAMILY RESIDENTIAL	RMH MOBILE HOME PARK	MRO MID-RISE DEVELOPMENT	

CREATED BY:
CANTON TWP. PLANNING SERVICES
1150 S. CANTON CENTER ROAD
CANTON, MI 48188
(734) 394-5170
CREATED ON:
August 18, 2022

