

**PLANNING COMMISSION
CHARTER TOWNSHIP OF CANTON
NOTICE OF PUBLIC HEARING**

NOTICE IS HEREBY GIVEN pursuant to Michigan Public Act 110 of 2006, of the State of Michigan, as amended, and pursuant to the Zoning Ordinance of the Charter Township of Canton that the Planning Commission of the Charter Township of Canton will hold a Public Hearing on **Monday, December 7, 2020 at 7:00 p.m.** by electronic remote access on the following proposed Special Land Use request as provided in Section 27.03 of the Canton Township Zoning Ordinance:

CHERRY HILL PRESERVE CONDOMINIUMS - Consider request for Special Land Use approval for Single-Family Attached Residential Units as required in Section 11.02(B)(15) of the Zoning Ordinance on parcel nos. 052-99-0042-000, 052-99-0044-001 and 052-99-0044-002 at 39540 Cherry Hill Road. Property is zoned R-4, Single-Family Residential District and located north of Cherry Hill Road between Lotz Road and the eastern Township boundary.

To mitigate the spread of the COVID-19 pandemic, protect the public health, and provide essential protections to Canton Township residents; the Canton Township Planning Commission will conduct its meeting on Monday, December 7, 2020 at 7:00 p.m. by video teleconference in accordance with Michigan law.

Public comments may be submitted to patrick.sloan@canton-mi.org at any time prior to the meeting. Additionally, written comments addressed to the Planning Commission should be received at the Township Administration Building at 1150 S Canton Center Rd., Canton, MI 48188 by 4:30 p.m. on Monday, December 7, 2020. The Secretary or staff will read comments submitted within the Rules of the Planning Commission during the meeting. Members of the public who attend by telephone or video may address the Planning Commission during the public hearing period via videoconference.

Individuals may join the video teleconference by going to:

<https://us02web.zoom.us/j/89004395755>

Or iPhone one-tap:

1-646-558-8656 (89004395755#) or 1-301-715-8592 (89004395755#)

Or Telephone:

1-301-715-8592 or 1-312-626-6799

Webinar ID: 890 0439 5755

International numbers available: <https://us02web.zoom.us/j/89004395755>

SEE ATTACHED MAP

Greg Greene, Chairman
Publish: Newspaper - November 19, 2020

CN2134 - 111920 2.5 x 11.309

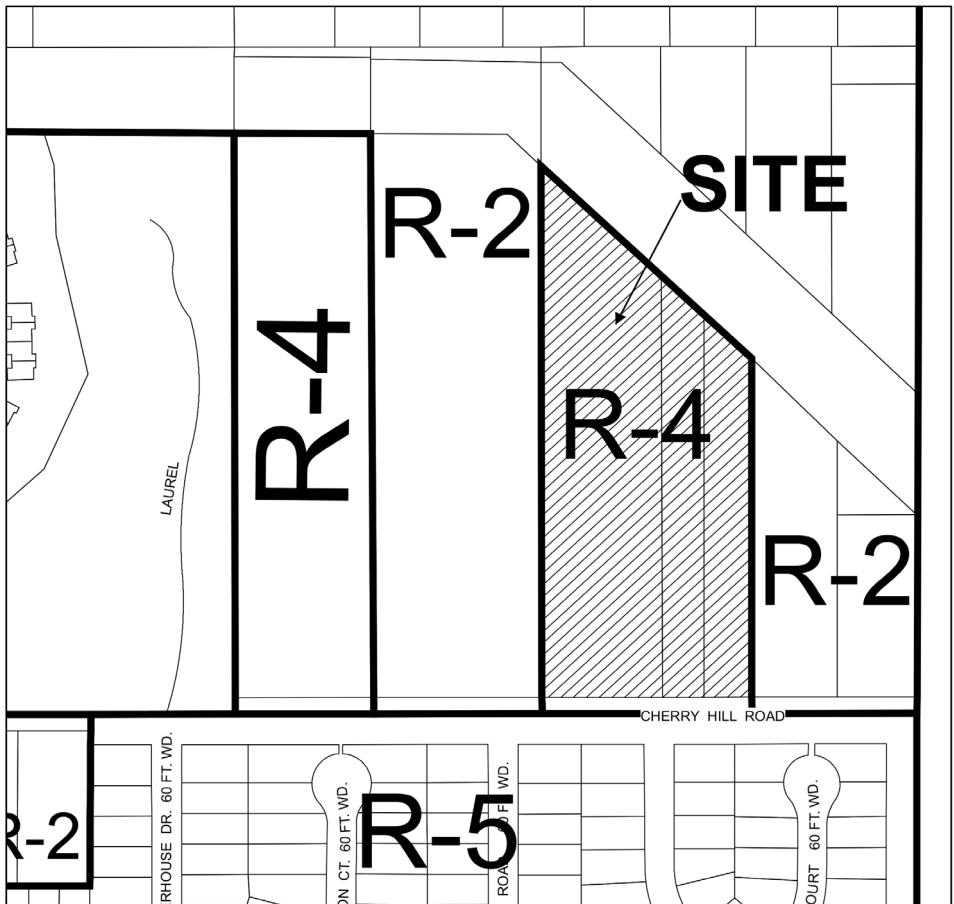

Cherry Hill Preserve Condos 052-SLU-6038

Zoning

WC WETLANDS CONSERVATION	R-3 SINGLE FAMILY RESIDENTIAL	C-1 VILLAGE SHOPPING	OSP OFF STREET PARKING
RA RURAL AGRICULTURAL	R-4 SINGLE FAMILY RESIDENTIAL	C-2 COMMUNITY COMMERCIAL	LI LIGHT INDUSTRIAL
RR RURAL RESIDENTIAL	R-5 SINGLE FAMILY RESIDENTIAL	C-3 REGIONAL COMMERCIAL	LI-R RESEARCH PARK
RE RURAL ESTATE	R-6 SINGLE FAMILY ATTACHED RESIDENTIAL	C-4 INTERCHANGE SERVICE	GI GENERAL INDUSTRIAL
R-1 SINGLE FAMILY RESIDENTIAL	MR MULTIPLE FAMILY RESIDENTIAL	O-1 OFFICE	
R-2 SINGLE FAMILY RESIDENTIAL	RMH MOBILE HOME PARK	MRD MID-RISE DEVELOPMENT	

